



ARTISTS | MUSICIANS | EVENTS

A space to share with the Austin community



Open Space

3,371 square feet of open space
Seated capacity: 155
Additional outdoor seating



Amenities

Climate controlled
Restrooms
High ceilings
Sound system available



Food/Catering

On-site food truck parking
Utility hookups
Easy access



Accessibility

Ample on-site parking
Garage door for easy load ins/outs
Minutes from South Congress Avenue and Downtown

SiteATX is a community art space located in a revitalized warehouse district called The Yard, just minutes from Austin's iconic South Congress Avenue.

Ideally located between Still Austin Whiskey Co. and St. Elmo Brewing, SiteATX neighbors also include The Austin Winery, Spokesman, Music Lab, Soursop, and Madabolic.

In addition to community and private art events, we also host corporate parties and functions, ceremonies and receptions, marketing activations and product launches, pop-ups, birthday parties, and more.

Photo: Chelsea Laine Francis Photography

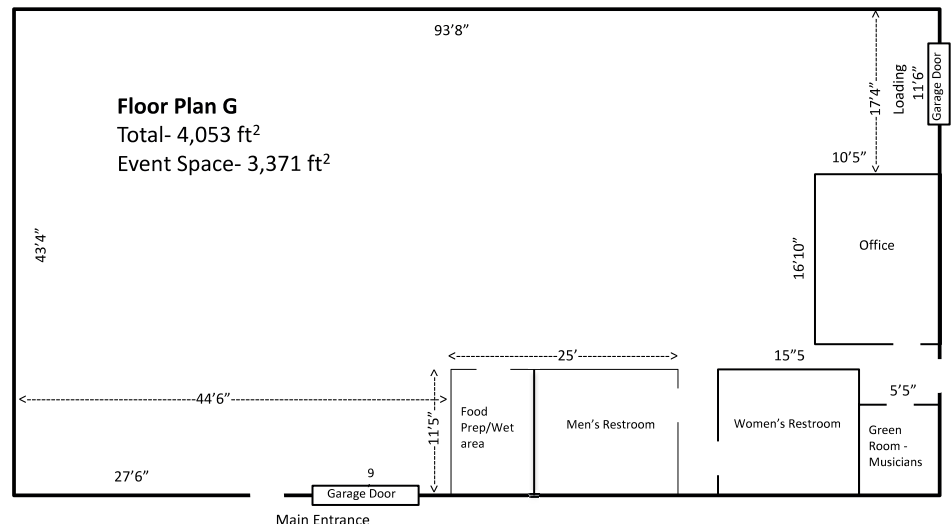
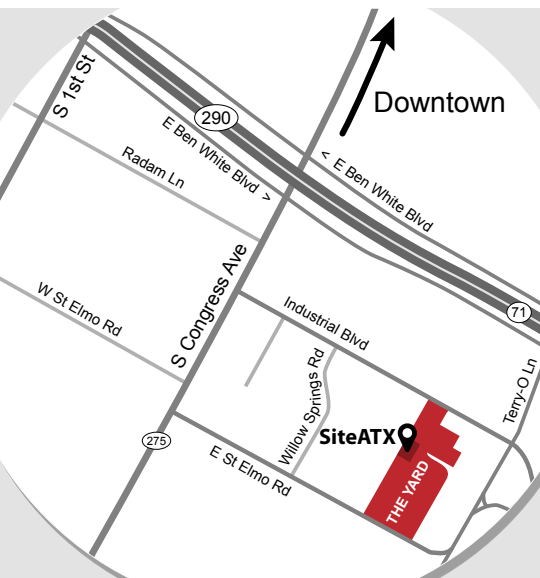

SiteATX | 440 East St. Elmo Rd. Building G | Austin, TX 78745
www.siteatx.com | info@siteatx.com